

# BA/MA (4+1) Program In Interior Design

## Description & Procedures

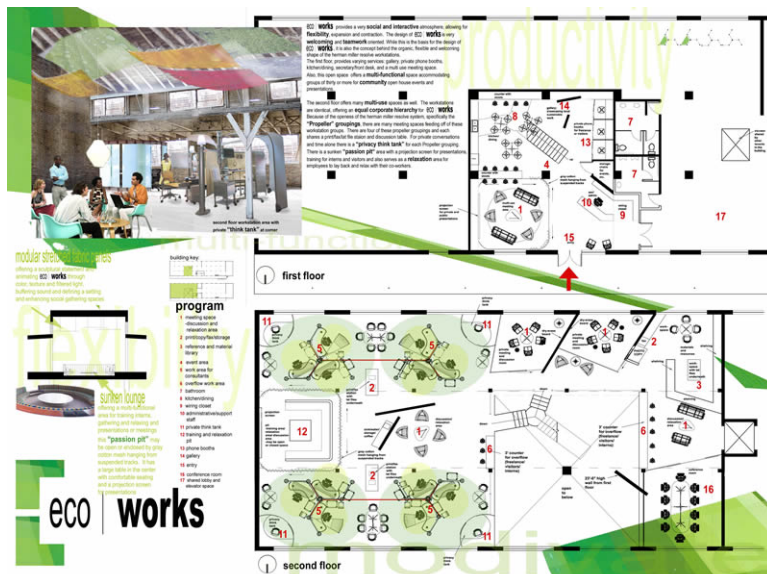

**TABLE OF CONTENTS**

Introduction	3
Sample Program of Study & Course Descriptions	4
Non-Thesis Project	5
Schedule for Graduating May 2007	7
Admissions Procedures	8
Departmental Application Form	9
List of Previous Graduates	10
Faculty Profiles	11

## **THE BA/MA INTERIOR DESIGN ARTICULATION PROGRAM AT WSU SPOKANE'S INTERDISCIPLINARY DESIGN INSTITUTE**

Washington State University Spokane offers an exciting BA/MA Interior Design Articulation program (4+1) that enables students to complete both a professional undergraduate degree and a graduate degree in interior design in five years. One of the few cutting edge interior design programs in the nation, it prepares students to acquire advanced specialization and creative design skills, while enhancing critical thinking and problem solving skills.

Qualified students may apply for entry into an articulated BA/MA degree program the last year of undergraduate study at WSU that leads to a master's degree completed in one year of graduate study. The BA/MA degree is a non-thesis degree and culminates in a design project.

The goals of the program are:

- To provide students with opportunities to explore advanced design theories, problem-solving techniques, methodologies, and individual research and design applications;
- To provide students with opportunities for interdisciplinary exchange through the core curriculum at the Interdisciplinary Design Institute;
- To contribute to and advance the body of knowledge pertaining to interior design and the built and natural environments;
- To prepare graduates to pursue careers as interior design educators, directors of interior design research, and/or practitioners of interior design.

## SAMPLE PROGRAM OF STUDY

4 <sup>th</sup> Year Fall Semester			4 <sup>th</sup> Year Spring Semester		
Prefix and Course Title	Gr.	Cr.	Prefix and Course Title	Gr.	Cr.
Tier III Capstone, GER or elective*	_____	3 cr	ID 392 Professional Procedures*	_____	3 cr
ID 425 Adv. Planning & Design I	_____	5 cr	ID 415 Adv. Construction Detail	_____	3 cr
ID 460 Portfolio	_____	3 cr	ID 426 Adv. Planning & Des. II	_____	5 cr
Arch 472 Codes & Acoustics	_____	3 cr	ID 540 Research Methods	_____	3 cr
			ID 594 Readings in Interior Des.	_____	3 cr
*See list of recommended electives in BA/MA Program Description & Procedures			*Students interested in pursuing the BA/MA degree are recommended to take ID 392 in the 3 <sup>rd</sup> year		
<ul style="list-style-type: none"> <li>▪ Apply for admission to 4+1 by Nov. 27</li> </ul>			<ul style="list-style-type: none"> <li>▪ Identify research topic &amp; committee chair by May 1</li> </ul>		
Total Credit hrs		14	Total credit hrs		17
5 <sup>th</sup> Year Fall Semester			5 <sup>th</sup> Year Spring Semester		
Prefix and Course Title	Gr.	Cr.	Prefix and Course Title	Gr.	Cr.
ID 525 Graduate Studio I	_____	5 cr	ID 526 Graduate Studio II	_____	5 cr
ID 530 Philosophy & Theory	_____	3 cr	ID 702 Master's Project	_____	2 cr
ID 560 Interdisciplinary Seminar	_____	3 cr	Supportive Elective (graded)	_____	3 cr
ID 702 Master's Project	_____	2 cr	Supportive Elective (graded)	_____	1 cr
<ul style="list-style-type: none"> <li>▪ Attend Orientation August 18</li> <li>▪ Submit name of committee chair to Graduate Coordinator by September 5</li> <li>▪ Program of Study due September 29</li> <li>▪ Proposal Presentation December 11</li> </ul>			<ul style="list-style-type: none"> <li>▪ Progress Presentation February 27</li> <li>▪ Application for Degree due March 5</li> <li>▪ Document to Chair by March 6</li> <li>▪ Document to committee by March 27</li> <li>▪ Schedule final oral exam by April 10</li> <li>▪ Final oral presentations April 24</li> <li>▪ Exhibit of projects April 30-May 4</li> <li>▪ Final documents due by May 4</li> </ul>		
Total credit hrs		13	Total credit hrs		11

### GRADUATE COURSE DESCRIPTIONS

#### **ID 525 Interior Design Graduate Studio I:**

Application of advanced design theories, philosophies, and research methodologies to enhance undergraduate design foundations through interdisciplinary studio experiences

#### **ID 526 Interior Design Graduate Studio II:**

Individual thesis topics and the application of advanced design theories, philosophies, and research methodologies to students focus topic.

#### **ID 530 Philosophies & Theories of the Built Environment**

Focuses on systematic thought that may describe the behavior of the built environment.

#### **ID 540 Research Methods**

Covers a variety of research methods from quantitative to technical to philosophical, directed towards qualitative research.

#### **ID 560 Interdisciplinary Seminar I**

Explores approaches to design thinking in the topic areas of people and place, history, theory and criticism, and physical design.

#### **ID 594 Readings in Interior Design**

Exploration of current topics through readings in Interior Design.

## MASTER'S NON-THESIS PROJECT

### Substance and Scope of the Project

---

The project may focus on any of a wide range of design problems. The method for approaching the project is the design process. A clearly defined analytical framework will be required to guide this process. You will develop this framework in consultation with your faculty mentor (Chair) based on the state of knowledge and theory regarding the topic, as well as the feasibility of your project. The following categories and frameworks suggest some of the possibilities that you might consider, bearing in mind the areas of concentration of the faculty: **History, Theory & Criticism, Physical Design, and People & Place**. They are neither exhaustive nor limiting.

1. The design of spaces for special populations
2. Sustainable issues in the built environment
3. Universal design solutions
4. Technical issues in the near environment
5. Environment and behavior
6. Aesthetics
7. Functionalism
8. Socio-Cultural considerations

### Essential Components of the Project

---

There are several activities that must be accomplished during the preparation of the project. Some of them are initiated early and some are continued throughout the project. You must document the entire design process as part of your final product. The following comments highlight key components of the process.

1. Literature review. The literature review must be initiated early during the exploration of possible topics because you need to determine what is already known (and what is not known) about the topic and how others have studied it. The literature review is essential in the development of your analytical framework. The literature review is a broad library search drawing from monographs, journals and other published reports. Your search should be thorough and should include the most recent and relevant material. Also you need to be sensitive to the quality of literature reviewed. You must judge among inconsistent or contradictory information and determine what is applicable to your design project.

The literature review usually involves several categories of literature. First there is information regarding the topic of investigation itself. Next there is information regarding the relevance of the topic to interior design or design in general. Of equal importance is information regarding the design strategy or analytical framework for the project. An important task during the literature review is the classification of appropriate material.

Documentation of the literature review must be incorporated in your final product. Most typically a chapter is dedicated to literature review. However, documentation of the literature may be distributed throughout the paper.

2. Course review. One purpose of the project is to synthesize your understanding of the field. A thoughtful review of coursework with your faculty mentor (Chair) supports your exploration of topics for the project. You should screen both required courses and elective courses for ideas, approaches, and techniques that can be applied in the project. Specifically, you should look for relationships among the material taught in different courses that can be used in the development of the project.

The course review contributes directly to the literature review in that it identifies both categories and sources to include and helps you define the design process. While it contributes directly to the development of your design project, it does not appear as a written chapter in your final product.

3. Design proposal and committee. A written design proposal becomes a contract between you and your faculty mentor (Chair) regarding the focus, the framework and the schedule for completion of your project. It represents a transformation or narrowing of a general topic into a specific design proposal. This proposal should be well thought out and well written so that there is no question how the work is to be pursued. It is a plan and a commitment on both your part and your mentor's. You want your mentor to be satisfied that the project is clear, that the approach is manageable, and that you have the capability and the resources to complete the work. The following points should be covered:
  - a. Design statement. This should clearly and succinctly describe the design problem.
  - b. A justification of the relevance and importance of the topic to interior design or the design disciplines in general.
  - c. Brief discussion of the theoretical context or the analytical framework that will guide your design work.
  - d. A thorough explanation of the design process to be followed. This should include site identification, building footprint, and other relevant details.
  - e. Identification of information sources.
  - f. Specification of product or outcomes.
  - g. Tentative chapter outline for report.
  - h. Schedule of work program.
  - i. Identification of any necessary support services or special circumstances (e.g. human subjects approval).
  - j. Preliminary literature review or annotated bibliography.

Once the proposal has been approved, a copy should be filed with the Academic Coordinator along with the required form that identifies members of the project committee. [The project committee is constituted of three faculty members: the Chair—who must be a member of the interior design faculty, and two other members of your choosing. All committee members must hold at least master's degrees.]

4. Project execution. The design project will be carried out in conjunction with ID 526, the final studio in the MA ID curriculum. Your faculty mentor (Chair) will support and monitor the execution of your project based on your project proposal agreement. At the same time you will document the project execution, recording the design process and drafting chapters of your final paper.
5. Revision, editing and polishing. As with any design project, your work will be reviewed, critiqued and revised, narrowing to an acceptable design solution and end product. At the same time, your final paper will progress toward a completed document, written, read and revised to become a coherent piece.
6. Oral defense. The final conceptual stage is the oral defense of the project. The design project should be generally satisfactory to your faculty mentor (Chair) before the formal defense is scheduled. Your faculty mentor (Chair) will be joined by the project committee and outside jurors to review your work. The defense becomes a review of the design project, how the design process was executed and the outcomes. Any reservations about the process or question of the design interpretation may be raised. The results of the jury will be reported to your faculty mentor (Chair) and the graduate coordinator, who may accept the project as is, or require corrections before it is officially approved.
7. Filing. Final approved copies of your project document must be submitted to the department. The faculty mentor (Chair) and project committee may also require copies.
8. Exhibit. There will be a graduate show of all projects as a final requirement of the non-thesis project. Your faculty mentor (Chair) will coordinate this.

## Schedule for Graduating May 2007

<b>FALL 2006</b>		
Dates to Remember	Action Item	Notes
September 5	*Submit name of mentor/chair to Graduate Coordinator (McCoy)	
September 29	Submit completed Program of Study form to Academic Coordinator (Rice)	Requires all committee signatures. Forms are available online at <a href="http://www.wsu.edu/~gradsch/forms.htm">http://www.wsu.edu/~gradsch/forms.htm</a>
December 11	(Stop/Go) Proposal Presentations take place	Requires all committee members to be present. Committee will determine if student is ready to proceed towards spring graduation (Go); or if more work is needed and a May graduation date is not likely (Stop).  For requirements of the proposal see item #3 on page 15 for a thesis; and item #3 on page 19 for a project, in the MA Interior Design Graduate Handbook.
<b>SPRING 2007</b>		
January 8 through February 27	Weekly meetings with mentor to discuss design and writing progress.	During this time students should be engaged in data collection, analysis and synthesis. Mentors provide timely feedback each week based on student progress in the aforementioned areas.
February 27	Progress Presentations take place	Requires all committee members to be present. Committee will determine if student has progressed adequately from Proposal Presentation to be ready for final oral defense in April.  Students should be prepared to present the progress of their thesis or project including a description of the research question(s) and theoretical framework, methods of data collection, a preliminary overview of the results and conclusions, and the strengths and weaknesses of the study.
March 5	Submit completed Application for Degree form to Academic Coordinator (Rice)	Forms available online at <a href="http://www.wsu.edu/~gradsch/forms.htm">http://www.wsu.edu/~gradsch/forms.htm</a>
March 6	Draft of Thesis or Project Document due to mentor/chair.	The mentor/chair will review the thesis or project document and provide feedback to the student within two weeks.
March 20	Draft of Thesis or Project Document returned to student from mentor/chair.	Student will make revisions based upon feedback from mentor/chair and have revised draft ready for dissemination to the entire master's committee within one week.
March 27	Draft of Thesis or Project Document due to entire master's committee.	Master's committee (including mentor/chair) will review the thesis or project document and provide feedback to the student within two weeks.
April 10	Submit Final Exam Scheduling Form to Academic Coordinator (Rice)  Pay \$50 graduation fee (Student Services)  Draft of Thesis or Project Document returned to student from entire master's committee.	Requires all committee signatures. Forms are available online at <a href="http://www.wsu.edu/~gradsch/forms.htm">http://www.wsu.edu/~gradsch/forms.htm</a>  Students completing a thesis degree must also submit a draft of the thesis to the Graduate School on this date.
April 24	Final oral presentations for both theses and projects	Students should be prepared to present the results of their thesis or project including a description of the research question(s) and theoretical framework, methods of data collection, a discussion of the results and conclusions, the strengths and weaknesses of the study, and future implications for further research.
April 30-May 4	Exhibit of Projects	Students completing the non-thesis project option will participate in the exhibit.
May 4	Graduation	Congratulations, you can be proud of your accomplishment.

\* Beginning in 2006-2007, all graduate students will be required to submit the name of their mentor/chair by the end of the previous spring semester.

## ADMISSIONS PROCEDURES

Qualified students (those in their 4<sup>th</sup> year of the WSU BA Interior Design program with a cumulative GPA of 3.0 or above) interested in pursuing the 4+1 program must make application to the Department of Interior Design by November 27, 2006.

Departmental application forms are located on page 9 of this handbook, or can be picked up from Academic Coordinator Jaime Rice (SCLS 142, 358-7945, [jlrice@wsu.edu](mailto:jlrice@wsu.edu)).

The admissions committee will review all application materials and make recommendation for advancement into the program for qualified students. The following factors will contribute to the admissions decision:

- The personal statement of intent, writing sample, and the applicant's previous performance in interior design courses and studios as evaluated by the admissions committee.
- An interview conducted by at least two representatives from the admissions committee. The interview is to assess the applicant's strengths and interests in comparison with the goals and requirements of the 4+1 program.
- Submission and oral presentation of a design project (upon request).

Students will be notified before the start of spring semester whether or not they have been recommended for advancement into the program. Those students receiving favorable recommendation will be required to enroll in and complete ID 540\* (Research Methods) and ID 594\* (Readings) during the spring semester of their 4<sup>th</sup> year.

Students receiving favorable recommendation for advancement must also complete an official application with the WSU Graduate School. Graduate School application can be made on-line at <http://www.gradsch.wsu.edu>. The application fee is \$35.

PLEASE NOTE: Final admission to both the 4+1 program and the Graduate School will be contingent upon successful completion of ID 540 and ID 594 and all requirements for the baccalaureate degree.

\* Students must receive a grade of C or above in ID 540 and ID 594 in order for those courses to be used towards the graduate program of study.

# APPLICATION FORM

## BA/MA Interior Design Program

**To be completed by applicant: DUE NOVEMBER 27, 2006**

Student Name \_\_\_\_\_ E-mail Address \_\_\_\_\_

Mailing Address \_\_\_\_\_ ID Number \_\_\_\_\_

Interior Design Program GPA \_\_\_\_\_ Cumulative GPA \_\_\_\_\_ Expected Graduation Date \_\_\_\_\_

**Submit with this form the following:**

- A one-to two-page personal statement addressing: 1) your interest in pursuing the BA/MA program option; 2) your anticipated career path; 3) and specific areas of interest for your research project.
- One example of a written composition or paper.

**All applicants MUST:**

- Have a cumulative GPA of 3.0.

**Students recommended for advancement into the program will:**

- Enroll in and successfully complete ID 540 and ID 594 during the spring semester of the 4<sup>th</sup> year;
- Make official application to the Graduate School for the MA Interior Design for Fall 2007;
- Exhibit the maturity, professionalism, and commitment necessary to be successful in graduate school as assessed by the interior design faculty through review of application materials, and as evidenced during the required interview with representatives from the admissions committee.

Student Signature \_\_\_\_\_ Date \_\_\_\_\_

**Submit this form and required materials to Jaime Rice, Interdisciplinary Design Institute, Room 142, by November 27.**

**Questions? (509) 358-7945, [jlrice@wsu.edu](mailto:jlrice@wsu.edu)**

**To be completed by Interior Design Program**

Interview \_\_\_\_\_ Cumulative GPA \_\_\_\_\_ Examples of Student Work \_\_\_\_\_

Faculty Recommendation: \_\_\_Admit \_\_\_Not Admit

Graduate Coordinator Signature \_\_\_\_\_ Date \_\_\_\_\_

Academic Coordinator Signature \_\_\_\_\_ Date \_\_\_\_\_

Department Chair Signature \_\_\_\_\_ Date \_\_\_\_\_

## PREVIOUS GRADUATES

The following is a selection of previous graduates highlighting their research projects and current employers.

<b>NAME</b>	<b>GRAD DATE</b>	<b>PROJECT TITLE</b>	<b>CURRENT EMPLOYER INFO</b>
Kate Hauge	May 2005	An Exploration of Haptic Space in Interior Design	Independent contracting, Yakima
Robin Kudirka	May 2005	Playwright to Designer: A Translation of the Play-Development Process into a Place of Wellness	OMS, Spokane
Cyanna Goold	May 2004	Environments Conducive to Healing: Affects of Healing Principles on Hospital Patient Rooms	Callison, Seattle
Emily Moses	May 2004	Connecting Historic Preservation and Environmental Responsibility: Designing Within our Built Heritage	Burgess Weaver Design Group, Seattle
Ramie Simpson	December 2003	Theme and Experience in Restaurant Design: A Theory	JL Warren Interiors, Spokane
Darci Rohrbach	May 2003	The Urban Workplace: Coherence of Nature in the Built Environment	BCRA Design, Tacoma
Jamie Herring	May 2003	The Language of Light	IA, Seattle
Stefanie Powell	May 2003	Creating Place in Retail Space	Callison, Seattle
Ann Wolf	May 2002	The Ritualistic Role of Water	Displaymakers, Seattle
Cindy Lee	May 2002	Interpreting Natural Light Qualities and Effects Through Light Modeling	Holland Roth Architects, Edmonton
Lars Gresseth	May 2002	A Re-Conceptualization of Interior Building Components as Dynamic Systems	Malcomb Architects, Irvine CA

Copies of previous project documents are located in the Resource Room, SCLS 254.

## FACULTY PROFILES

### Interior Design

---

The Interior Design faculty mentor graduate students by advising and teaching, making contributions to readings and research methods seminars, supervising independent study projects and serving on graduate committees. MA Interior Design students choose major advisors and committee chairs with compatible interests for study and research.

#### **Nancy Blossom, MA, FIDEC, IIDA**

---

Professor and Director, Interdisciplinary Design Institute  
 Research: History theory and criticism, environment-behavior relationships, curriculum and pedagogy.  
 E-mail: blossom@wsu.edu

#### **Nancy Clark Brown, B.Arch, MS**

---

Associate Professor, Department Chair  
 Research: Innovative teaching methodologies; lighting design, theoretical and spatial frameworks of the body in interior space.  
 E-mail: ncbrown@wsu.edu

#### **Tina Johansen, MS**

---

Assistant Professor  
 Research: Design accuracy versus design creativity; codes and regulations as they relate to accessibility design; how the design of the built environment affects disabled tenants' satisfaction with their living environment; universal design.  
 E-mail: johansen@wsu.edu

#### **Robert Krikac, MS**

---

Associate Professor  
 Research: The integration of history, theory and research with the practice of interior design; sketching as thinking; interdisciplinary design and issues related to the design of commercial offices.  
 E-mail: rkrikac@wsu.edu

#### **Janetta McCoy, MS, PhD**

---

Associate Professor, Graduate Coordinator  
 Research: The impact of the physical work environment on the intellectual and physical performance of people within organizations; leadership in design and creative teamwork; stress as an outcome of the work environment; gender bias in teaching evaluations; design for children with autism and development disabilities.  
 E-mail: janettamccoy@wsu.edu

#### **Matt Melcher, M.Arch**

---

Assistant Professor  
 Research: Poetics of assembly, detail and materiality, graphic communication, and representative; urban space as interior design; light and phenomenology; process as product in the design discipline.  
 E-mail: melcher@wsu.edu

#### **Linda Nelson Johnson, MA**

---

Associate Professor, Interior Design; Assistant Director of Interior Design  
 Research: Gender issues and diversity in design; historic preservation of structures, interiors and ornamentation; design foundation pedagogy.  
 E-mail: lnj@wsu.edu

#### **Jo Ann Asher Thompson, MA, PhD, FIDEC, FIIDA**

---

Professor; Vice Chancellor, Washington State University Spokane  
 Research: Environment-behavior relationships; distance learning education; cognitive perceptions of interior space; linking education and practice; criticism and theory.  
 E-mail: jatadm@wsu.edu

---

**John Turpin, MS**

Associate Professor

Research: Interior design history; women's studies in interior design; design criticism and theory.

E-mail: [jturpin@wsu.edu](mailto:jturpin@wsu.edu)

---

**Interdisciplinary Design Institute**

Faculty members from other disciplines within the Interdisciplinary Design Institute or the University at-large may be used for the master's committee as approved by the Chair of the Department. For complete faculty bio information, visit <http://www.idi.spokane.wsu.edu>.

---

**John Abell, M.Arch, PhD, AIA**

Associate Professor, Architecture

Research: Architectural design and its relations with the histories and theories of design, aesthetic experience and representation, spatial empathy, urban material culture, material technologies, generative processes and investigative practices of design.

E-mail: [abellj@wsu.edu](mailto:abellj@wsu.edu)

---

**Kerry Brooks, MUP, PhD**

Associate Professor, Landscape Architecture; Director, GIS &amp; Simulation Laboratory

Research: Geographic information systems, visualization, land use and environmental planning; image processing and remote sensing; planning research methods and applications.

E-mail: [kerrybrooks@wsu.edu](mailto:kerrybrooks@wsu.edu)

---

**Matthew Cohen, M.Arch**

Assistant Professor, Architecture

Research: Medieval and Renaissance design principles, American vernacular architecture and urbanism, observation-based research methodologies.

E-mail: [cohenm@wsu.edu](mailto:cohenm@wsu.edu)

---

**Bob Scarfo, MLA, PhD**

Associate Professor, Landscape Architecture

Research: Spatial implications of successful aging; social basis of design; neighborhood and small town planning and design as related to health.

E-mail: [scarfo@wsu.edu](mailto:scarfo@wsu.edu)

---

**David Wang, M.Arch, PhD**

Professor, Architecture

Research: Art and architectural aesthetics; east-west philosophies of architecture, research methods for architecture.

E-mail: [davewang@wsu.edu](mailto:davewang@wsu.edu)

## ADMINISTRATIVE STAFF

### **Academic Coordinator**

---

Jaime Rice, EdM  
Phone: (509) 358-7945  
E-mail: jlrice@wsu.edu

### **Department Secretary**

---

Dori Roberts  
Phone: (509) 358-7511  
E-mail: dori@wsu.edu

### **Program Assistant**

---

Kristie Wardrop  
Phone: (509) 358-7963  
E-mail: wardrop@wsu.edu

### **Assistant to the Director**

---

Pam Medley  
Phone: (509) 358-7920  
E-mail: pmedley@wsu.edu

### **Information Technology Tech II**

---

Ben Aichele  
Phone: (509) 358-7650  
E-mail: benaichele@wsu.edu